

45° branch diverters, pressed, manual

Suggestion for use of JKF bends. Example shows a trouser diverter and two 15° bends.

Pressed diverters are made of 1.50 - 2.00 mm sheet metal (s) with a standard 2.00 mm damper suspended on brass bearings.

Supplied as standard with left branch.

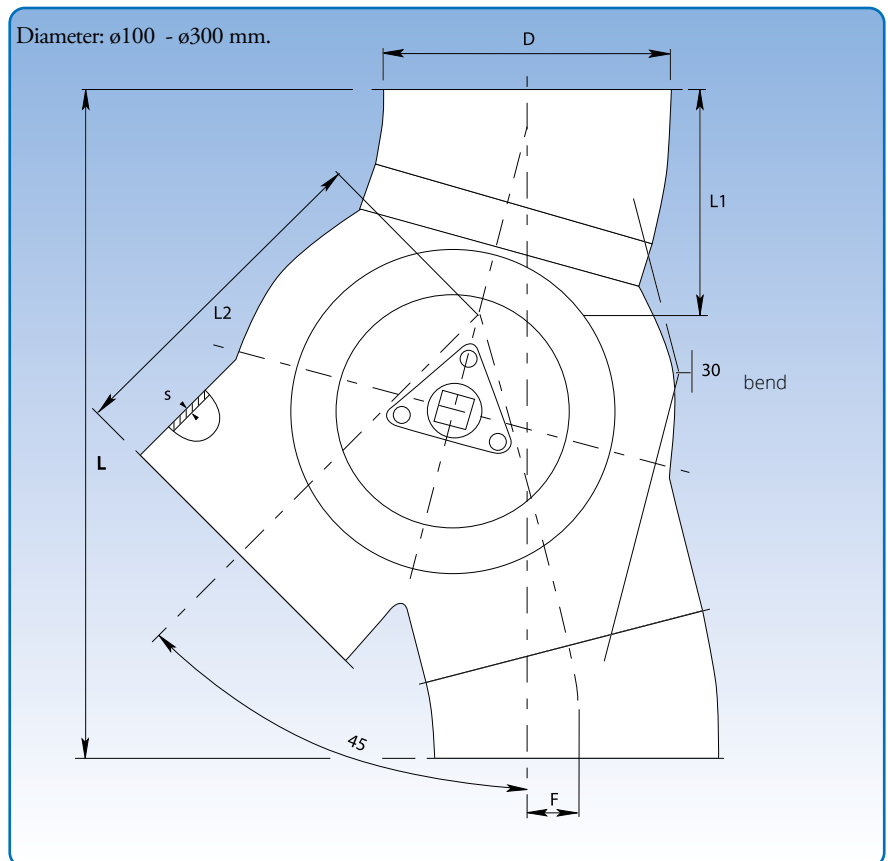

Dimensional specifications are given in the table below.

Dimensions							Weight kg
D mm	s mm	F mm	L mm	L1 mm	L2 mm		
100	1,50	25	270	100	145	2,80	
120	1,50	25	380	145	240	5,90	
125	1,50	25	335	120	170	5,30	
150	2,00	30	375	135	190	7,80	
160	2,00	40	410	130	225	7,80	
180	2,00	40	600	230	315	13,40	
200	2,00	40	455	155	230	11,30	
250	2,00	35	550	190	270	17,70	
300	2,00	55	660	230	325	25,90	